

MECHANICAL DISCHARGE AID SAD DISCHARGE AND DOSING SYSTEM



The SAD 300/65 will be used for discharging of very hard flowing bulk products out of silos or bunkers.
The SAD is very suitable for handling of quick lime, activated carbon, gypsum etc.
The installation in existing applications is possible without problems.

Application

- Robust design
- Suitable for special applications
- Easy installation
- Easy maintenance
- Temperature of operation -10° - 80°C

Details / Design

- Designed in stainless steel AISI 304 / AISI 316 glass bead blasted
- Designed in constructional steel S235JR
Sandblasting SA 2 ½ .
painting: RAL 9006 white aluminium

Finish

The vertical agitator is driven by a gear motor separately. It breaks up the product and loosens the product in the outlet area. A steady and smooth discharge will be ensured out of a silo or bunker .

Function

The horizontal discharge and dosing screw is designed with a progressive pitch. It allows a controlled discharge with constant volume flows

The screw is driven by a gear motor which is designed for operation at a frequency converter. A variable operation is possible to realise volume flows 15 up to 75 Liter/h.

Dimension sheet

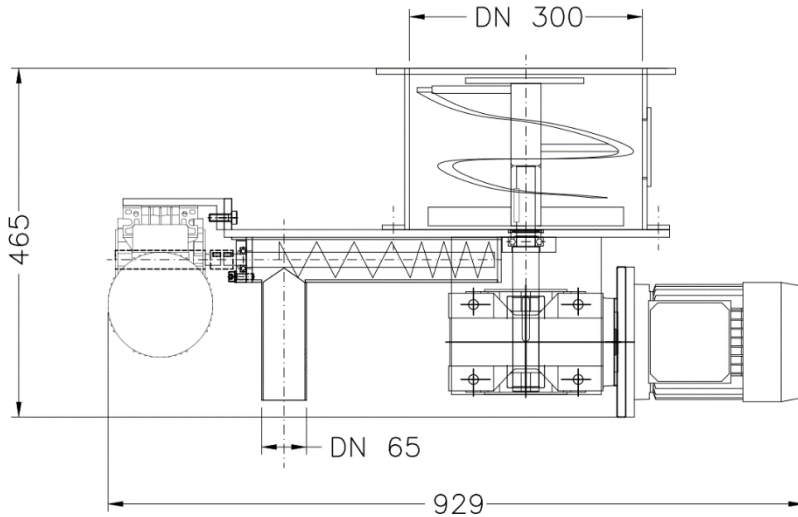

Process of discharge



Technical Data SAD 300/65

SAD 300/65	
DN300 – (other sizes on request)	
Discharge and dosing capacity	15 bis 75 Liter/ h
Electr. Power Dosage	0,25 kW; 230/400V; IP55; suitable for use at frequency converter
Electr. Power agitator	0,55 kW; 230/400V; IP55,

Article Number

Design	Structural steel	Stainless steel
Article number	782 10 017	782 10 018

Other sizes and applications according to your requirements on request.

Please provide the characteristics of the media to be extracted when you make an inquiry: e.g. Cement, lime, feed, salt, sugar, etc.

Notice

